

HOFMANN® 

geodyna® **7100**



CAR WHEEL BALANCER

ENGINEERING UNLEASHED™

CAR WHEEL BALANCER WITH LED DISPLAY

The geodyna® 7100 by Hofmann® is a compact semi-automatic wheel balancer suitable for various shop sizes. It streamlines wheel balancing with its intuitive LED display and touchpad controls on the weight tray. Its user-friendly 2D SAPE data entry and smartSonar™ technology measure wheel width and eliminate manual entry errors. Its efficient belt-driven, one-spin balance ensures speedy and precise results, making the geodyna® 7100 a valuable addition to any shop.



DIGITAL LED DISPLAY

Weight-tray integrated touchpad operation with intuitive LED display.



QUICK NUT CLAMP

An easy-to-use manual clamping device that allows a secure attachment of the wheel to the balancer shaft.



SEMI-AUTOMATIC DATA ENTRY

With its intuitive gauge arm and easyALU™ technology, the system lets technicians touch the rim, automatically logging dimensions and selecting the correct weight-balancing mode.

QUICKBAL™

Engineered for optimal performance, this feature intelligently adjusts the number of revolutions according to each wheel's specifications. Operating at maximum speed, it effectively reduces cycle time, delivering swift and efficient results.

EZ-COLLETS

The EZ-Collets mobile app helps technicians find the right collet, flange plate or speed quick plate for their job by selecting the vehicle. They can then compare and assess the available tools' benefits.

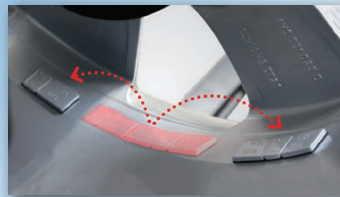

SPLIT WEIGHT MODE

This feature ensures accurate balancing and discreet weight concealment behind spokes, maintaining the wheel's aesthetic appeal and visual presentation.



WHEEL COVER

The wheel cover prevents objects from flying, protecting technicians from possible accidents.

TECHNICAL SPECIFICATIONS

Part Number	EEWB761A
Semi-Automatic Rim Diameter Range	8" - 25" 20 - 63.5cm
Semi-Automatic Width Range	1" - 20" 2.54 - 50.8cm
Manual Rim Diameter Range	8" - 32" 20 - 81.2cm
Manual Rim Width Range	1" - 20" 2.54 - 50.8cm
Max Wheel Diameter	38" 96.5cm
Max Wheel Weight	154 lbs. 70 kg
Power Supply	115V 1Ph 60Hz
Dimensions HxWxL	59" x 51.5" x 52" 150 x 131 x 132cm

STANDARD ACCESSORIES

- Four Cone Set
- Weight Pliers
- Rim Width Caliper
- Weight Remover Tool

OPTIONAL ACCESSORIES

- Light Truck Cone Kit (8100068)
- 9 Collet Set (EAK0375G07A)
- Speed Plate Kit (EAK0390G24A)
- Storage Stand (EAK0309J67A)



US 800.251.4500

CANADA 800.267.2185



Snap-on® Total Shop Solutions offers a wide range of garage equipment solutions for workshops, garages, car dealers and tire shops, thanks to the specific solutions provided by its portfolio of premium brands. Hofmann® is a brand of TSS and is committed to product innovation and improvement. Therefore, specifications listed in this sell sheet may change without notice. ©2023 Snap-on Incorporated. Hofmann® is a trademark, registered in the United States and other countries, of Snap-on Incorporated. All rights reserved. All other marks are marks of their respective holders. sswb23001 10/2023

HOFMANN

HOFMANN-EQUIPMENT.COM