

HOFMANN® 

geodyna® **7100**



CAR WHEEL BALANCER

ENGINEERING UNLEASHED™

geodyna® 7100

CAR WHEEL BALANCER WITH LED DISPLAY

The geodyna® 7100 is a compact semi-automatic wheel balancer suitable for various shop sizes. It streamlines wheel balancing with intuitive LED display and touchpad controls on the weight tray. User-friendly 2D SAPE data entry and smartSonar™ technology measure wheel width and eliminate manual entry errors. Efficient belt-driven, one-spin balance ensures speedy and precise results, making the geodyna® 7100 a valuable addition to any shop.



SEMI-AUTOMATIC DATA ENTRY

With its intuitive gauge arm and easyALU™ technology, the system lets technicians touch the rim, automatically logging dimensions and selecting the correct weight-balancing mode.

QUICKBAL™

Engineered for optimal performance, this feature intelligently adjusts the number of revolutions according to each wheel's specifications. Operating at maximum speed, it effectively reduces cycle time, delivering swift and efficient results.

TECHNICAL SPECIFICATIONS

| | |
|-----------------------------------|-----------------------------|
| Semi-Automatic Rim Diameter Range | 8" - 25" 20 - 63,5cm |
| Semi-Automatic Width Range | 1" - 20" 2,54 - 50,8cm |
| Manual Rim Diameter Range | 8" - 32" 20 - 81,2cm |
| Manual Rim Width Range | 1" - 20" 2,54 - 50,8cm |
| Max Wheel Diameter | 37,8" 96cm |
| Max Wheel Weight | 154 lbs. 70kg |
| Power Supply | 230V 1ph 50-60Hz |
| Dimensions HxWxL | 67"x39"x43" 171x100x110cm |



DIGITAL LED DISPLAY

Weight-tray integrated touchpad operation with intuitive LED display.



QUICK NUT CLAMP

An easy-to-use manual clamping device that allows a secure attachment of the wheel to the balancer shaft.

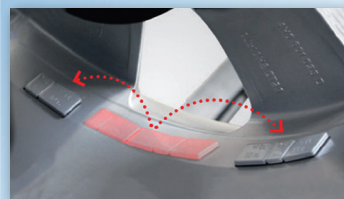

SPLIT WEIGHT MODE

This feature ensures accurate balancing and discreet weight concealment behind spokes, maintaining the wheel's aesthetic appeal and visual presentation.



WHEEL COVER

The wheel cover prevents objects from flying, protecting technicians from possible accidents. Not applicable for model 7100n.

STANDARD ACCESSORIES

- Integrated flange with quick-clamping nut
- Drum, drum cushion, 3 cones (1,7-3,2" | 42-80mm), (2,8-3,9" | 72-99mm), (3,8-4,6" | 96-116mm) dia.
- Universal weight pliers, adhesive weight removing tool
- Rim width calipers (WB without Smart Sonar™ only)
- 4 Storage pegs on left-hand side of machine
- Wheel guard

VERSION DIFFERENCES

- 7100 - All features
- 7100n - No wheel cover

FIND A DISTRIBUTOR

hofmann-equipment.com/en/distributor

AUSTRIA
+43 2641 24524

FRANCE
+33 134 48 58 78

GERMANY
+49 8634 622 0

ITALY
+39 0522 733 411



Snap-on® Total Shop Solutions offers a wide range of garage equipment solutions for workshops, garages, car dealers and tyre shops, thanks to the specific solutions provided by its portfolio of premium brands. Hofmann® is a brand of TSS and is committed to product innovation and improvement. Therefore, specifications listed in this sell sheet may change without notice. ©2023 Snap-on Incorporated. Hofmann® is a trademark, registered in the United States and other countries, of Snap-on Incorporated. All rights reserved. All other marks are marks of their respective holders. sswb23020 12/2023



HOFMANN-EQUIPMENT.COM

HOFMANN®